

Flanschkugelhahn, Edelstahl, gelagerte Kugel Flanged ball valve, stainless steel, trunnion mounted Typ PA-19TM.266/466.P

Technische Daten

Bauform

Voller Durchgang
 2-teilig
 Flansche nach DIN PN 16 oder 40
 Gehäuse: 1.4408
 Kugel: 1.4408
 Dichtung: TFM-1600
 gelagerte Kugel
 mit Schneckenradgetriebe und
 ISO-Aufbauflansch

Specification

Design

Full port
 2-pc.
 Flanges according to DIN PN 16 or 40
 Body: 1.4408
 Ball: 1.4408
 Seat: TFM-1600
 Trunnion mounted
 with gearbox and
 with ISO-Mountingpad



PA-19TM.266.P (PN 16)

PA-19TM.266.P (PN 16)

PA-19TM.466.P (PN 40)

PA-19TM.466.P (PN 40)

Anschluss

Flanschanschluss

Connection

with flanges

Betriebstemperatur

max. 180°C

Temperature Range

max. 180°C

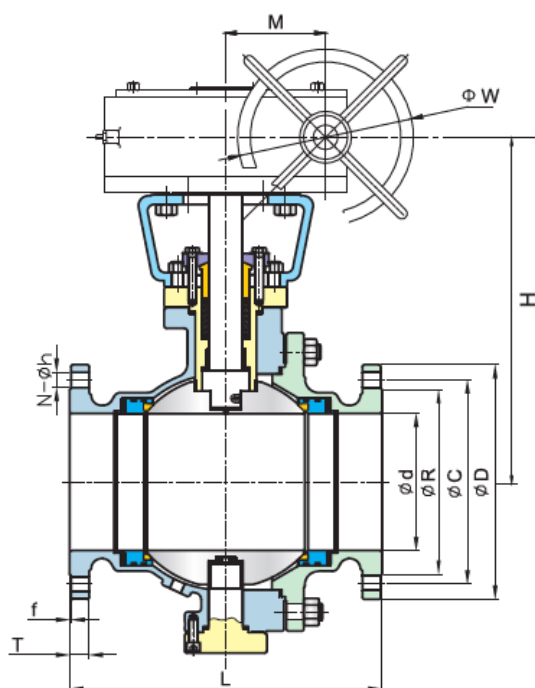

DN150~DN300
 (2-PC Body)

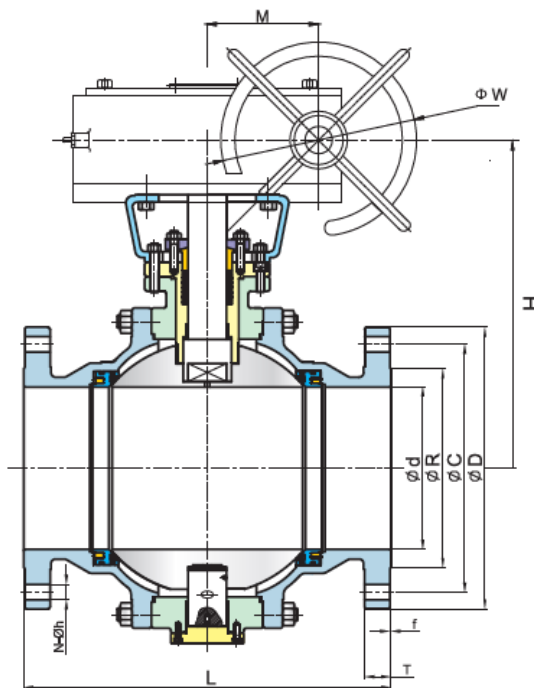

DN350~DN600
 (3-PC Body)

Size	PN	d	L	R	C	D	f	T	N	h	H	W	M	ISO 5211 on Valve
DN 150	16	150	394	212	240	285	2	22	8	22	420	400	105	F16
	40	150	403	218	250	300	2	28	8	26	420	400	105	
DN 200	16	200	457	268	295	340	2	24	12	22	485	400	105	F16
	40	200	502	278	320	375	2	34	12	30	485	500	120	
DN 250	16	250	533	320	355	405	2	26	12	26	500	500	126	F16
	40	250	568	345	385	450	2	38	12	33	500	500	126	
DN 300	16	300	610	378	410	460	2	28	12	26	540	500	126	F25
	40	300	648	410	450	515	2	42	16	33	540	500	126	
DN 350	16	336	686	438	470	520	2	30	16	26	630	500	126	F25
	40	336	762	465	510	580	2	46	16	36	630	710	138	
DN 400	16	387	762	490	525	580	2	32	16	30	680	710	138	F25
	40	387	838	535	585	660	2	50	16	39	680	710	138	
DN 450	16	438	864	550	585	640	2	40	20	30	720	710	138	F25
	40	432	914	560	610	685	2	57	20	39	720	710	138	
DN 500	16	489	914	610	650	715	2	44	20	33	760	710	138	F30
	40	483	991	615	670	755	2	57	20	42	760	710	138	
DN 600	16	590	1067	725	770	840	2	54	20	36	890	710	138	F30
	40	584	1143	735	795	890	2	72	20	48	890	800	150	

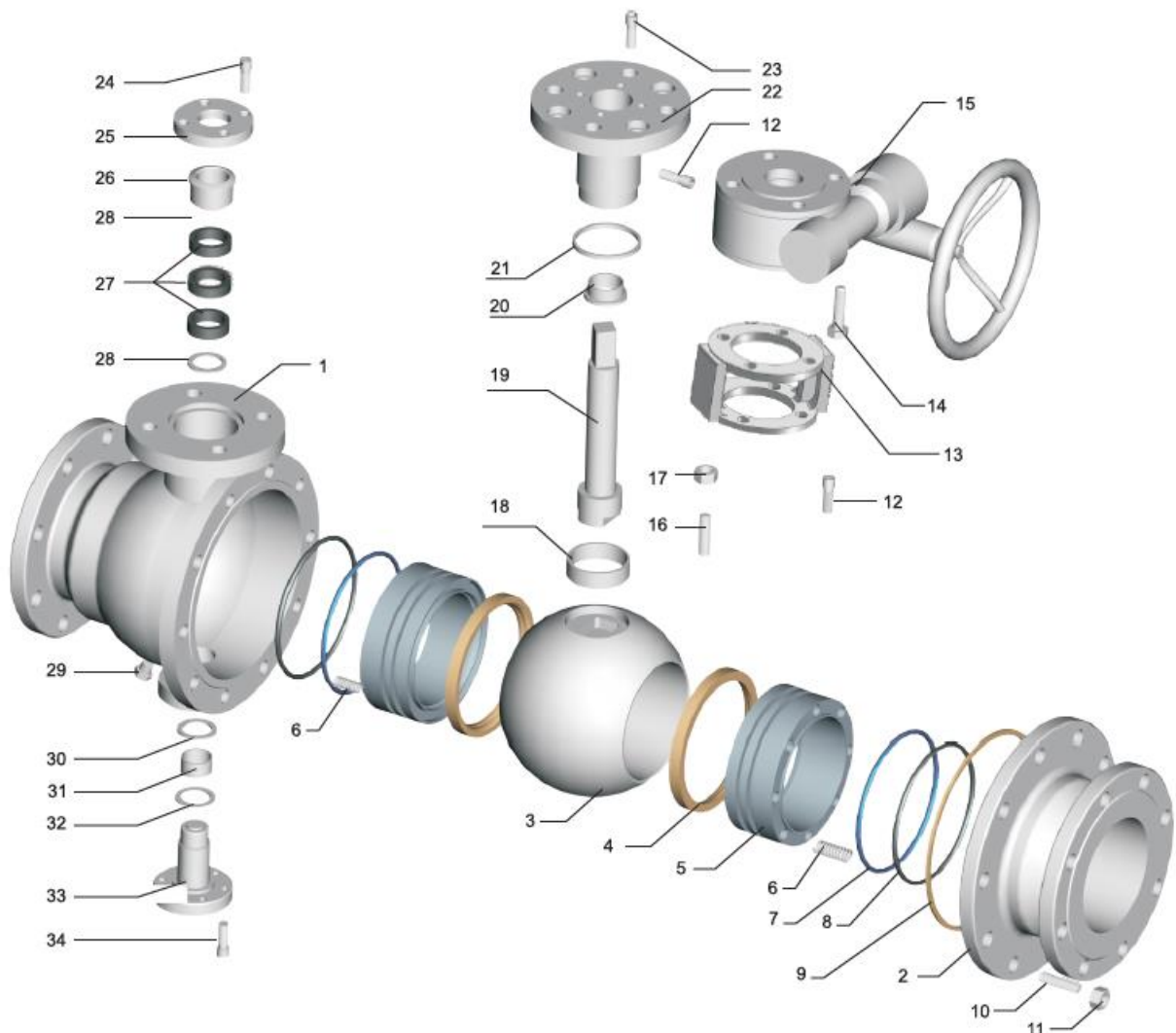

NO.	Part Name	Materials
1	Body	A351-CF8M
2	Body Cap	A351-CF8M
3	Ball	A182-F316
4	Seat Seal	TFM1600
5	Seat	A182-F316
6	Spring	SUS631/Inconel X-750
7	O-Ring	FKM/Silicon
8	Sealing Ring	Grafoil/FKM
9	Body Gasket	316 Spiral Wound + Grafoil / FKM
10	Stud	A193-B8
11	Hexagon Nut	A194-8
12	Injection Sealing	SUS316
13	Yoke	A216-WCB
14	Hexagon Bolt	A193-B8
15	Worm Gear	Package
16	Stud Bolt	A193-B8
17	Hexagon Nut	A194-8
18	Wear Sleeve	50%SS + 50%PTFE
19	Stem	A182-F316
20	Stem Sleeve	50%SS + 50%PTFE
21	Mid. Flange Gasket	316 Spiral Wound + Grafoil / PTFE
22	Mid. Flange	A351-CF8M
23	Hexagon Socket Cap Head Screw	A193-B8
24	Hexagon Socket Cap Head Screw	A193-B8
25	Packing Plate	A351-CF8
26	Gland	A351-CF8M
27	Stem Packing	Grafoil / PTFE
28	Packing Gasket	316
29	Drain Plug	316
30	Bottom End Cap Wear Bushing	50%SS + 50%PTFE
31	Bottom End Cap Sleeve	50%SS + 50%PTFE
32	Bottom End Cap Seal Ring	316 Spiral Wound + Grafoil / PTFE
33	Bottom End Cap	A182-F316
34	Hexagon Socket Cap Head Screw	A193-B8